

The MOTOMAN MPP3 4-axis high-speed robot with parallel kinematic system combines the speed of the delta design with a high payload capacity and a large working range. Due to the high torque of the fourth axis, the so-called wrist axis, the MOTOMAN MPP3 moves payloads of up to 3 kg at unprecedented speeds.

The new “MPP 3” delta robot for demanding picking tasks rounds out the MOTOMAN product range from Yaskawa.

It was developed for the fields of order picking, high-speed picking and other handling applications, and is used primarily in the food and solar industries.



Key benefits

- Payloads with unprecedented speed:
 - 140 cycles per minute with 3 kg payload
 - 230 cycles per minute with 1 kg payload
- Total stroke of 500 mm with a working range of 1300 mm
- High-precision, high-speed conveyor tracking
- Maximum machine accuracy
- Space-saving installation directly above the conveyor
- Protection classification IP65

MOTOMAN MPP3

Handling, Palletizing, Picking and Packing

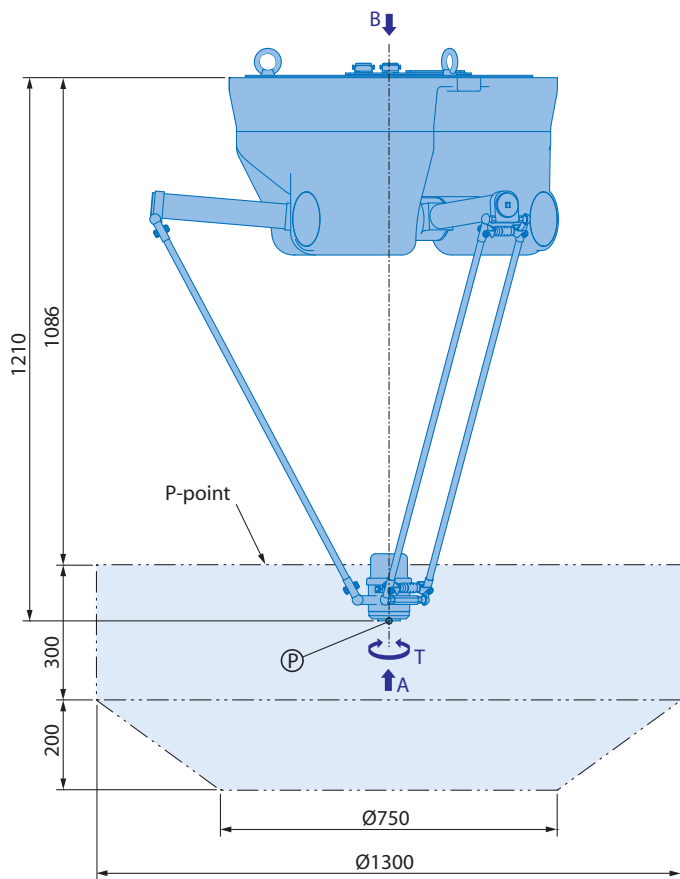

View B

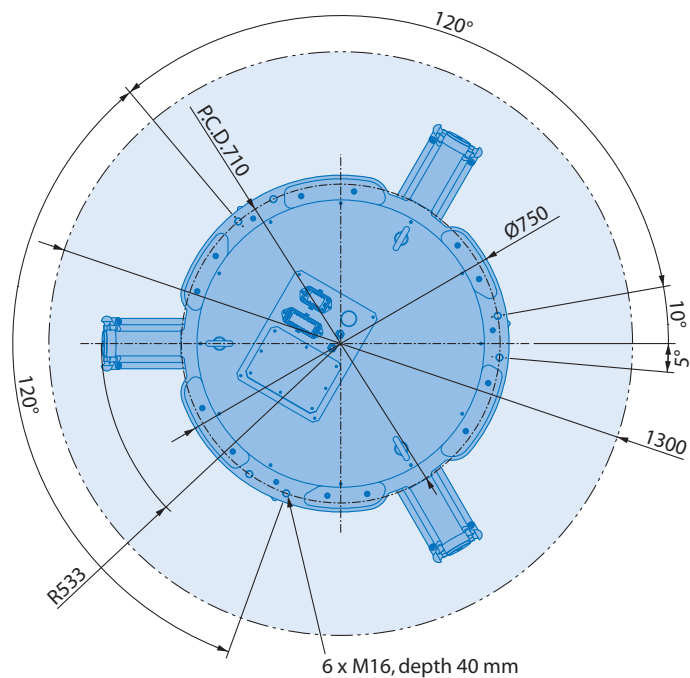

View A

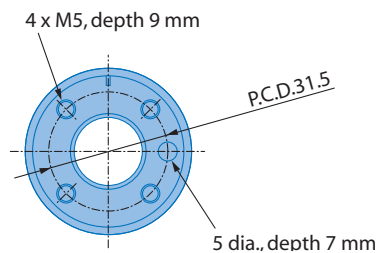

All dimensions in mm | Technical data may be subject to change without previous notice | Please request detailed drawings at robotics@yaskawa.eu.com – MPP3, A-05-2011, A-Nr. 152091

Specifications MPP3

Pattern	Payload [kg]	CPM	Payload [kg]	CPM	Controlled axes	4
25-305-25	1	230	3	170	Max. payload [kg]	3
300-400-100	1	100	3	80	Repet. pos. accuracy [mm]	±0.1
50-1000-50	1	120	3	85	Repet. rotational accuracy of T-axis [arc x min ⁻¹]	±1
70-700-70	1	130	3	95	Max. working range [mm]	R = 1300
Speed [mm/s]		Repet. pos. accuracy [mm]			Temperature [°C]	0 to +40
800		1			Humidity [%]	20 – 80
1300		1.5			Weight [kg]	115
2000		3			Power supply, average [KVA]	21.5
					IP class	IP65



Zentrale Robotics Division

YASKAWA Europe GmbH
Kammerfeldstraße 1
D-85391 Allershausen
Fon 0049-81 66-90-0
Fax 0049-81 66-90-103
robotics@yaskawa.eu.com
www.yaskawa.eu.com

YASKAWA Academy und Vertriebsniederlassung Frankfurt

YASKAWA Europe GmbH
Robotics Division
Hauptstraße 185
D-65760 Eschborn
Fon 0049-61 96-777 25-0
Fax 0049-61 96-777 25-39
robotics@yaskawa.eu.com
www.yaskawa.eu.com